

[2] Controller		
1. Model of controller	F61	
2. Structure	Outside air intake cooling system	
3. Dimensions	Refer to the attached drawings.	
4. Number of controlled Axes	Max. 10 axes (standard:4 axes each arm, option:2 axes)	
5. Drive system	Full digital servo	
6. Types of motion control	Manual mode	Coordinated arm operation, Single arm operation (Interpolation mode)Joint, Base, Tool operation mode
	Auto mode	Coordinated arm operation, Single arm operation (Interpolation mode) joint, Linear
7. Teaching method	Direct teaching or Simple programming by tablet	
8. Memory capacity	16 MB	
9. External operation signals	External Emergency stop	
10. Number of option board slots	2 slots	
11. Operation panel	Manual/Auto SW, Start/Stop SW, Emergency Stop SW	
12. Communication I/F	Ethernet (1000BASE-T/100BASE-TX/10BASE-T)	2 port
	RS-232C	1 port
	USB2.0	2 ports *option
	USB3.0	1 ports *option
13. Mass	Refer to the attached drawings.	
14. Power requirement	AC200-AC230V \pm 10% , 50/60Hz \pm 2% , single phase, Max. 2.0kVA *1	
15. Ground	Less than 100 Ω (robot dedicated ground), Leakage current: max. 10 mA	
16. Ambient temperature	5 \sim 40 $^{\circ}$ C	
17. Relative humidity	35 - 85 % (non-condensation)	
18. Color	Munsell 5Y8.5/1 equivalent	
19. General purpose signals	Input : 16, Output : 16	
20. Options	Power/Signal cable	
	Operation BOX	
	Number of additional I/O signals (IN:32 OUT:32 - max IN:64 OUT:64)	
	Field BUS	
	Primary power source cable	
	Tablet PC(Android OS) with application software	
21. Others	Please contact Kawasaki for maintenance parts and spare parts.	
<p>*1 Inrush current several to ten of times as many as steady current shall be caused instantaneously when the power is supplied or servo is turned on. Ensure to have enough power supply for the instantaneous high intensity since power supply voltage may drop because of the inrush current.</p> <p>*2 Please contact Kawasaki for the use of exceeding the conditions described above.</p>		

F61 CONTROLLER

MASS: 13.7Kg (Without any options)

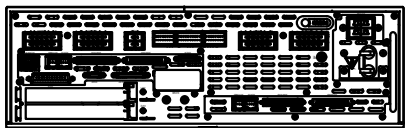

REAR VIEW

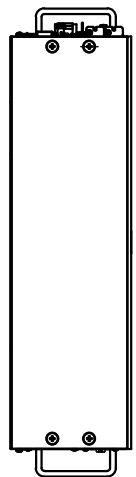

SIDE VIEW

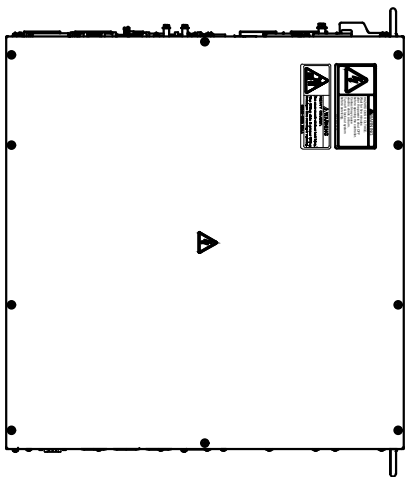

TOP VIEW

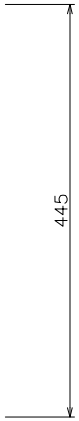

445

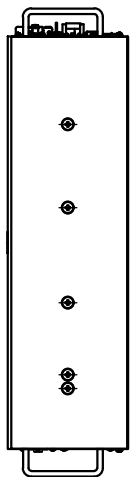

SIDE VIEW

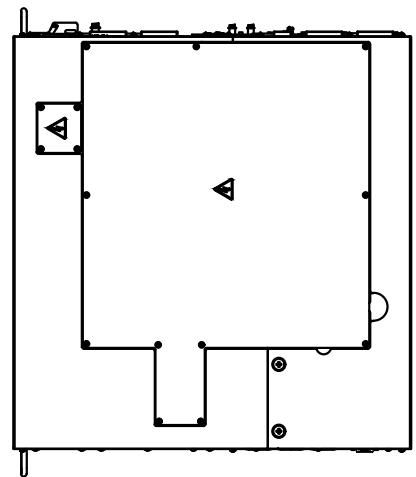

BOTTOM VIEW

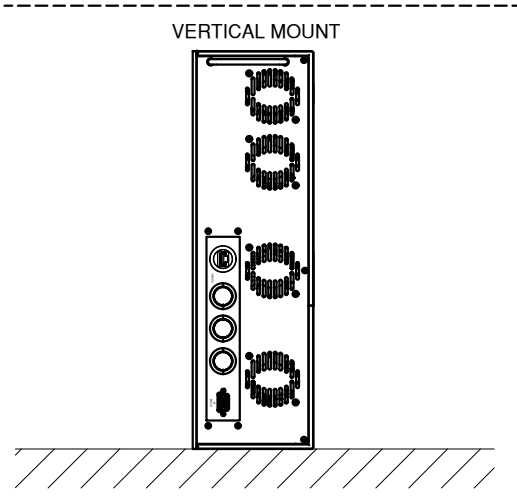

VERTICAL MOUNT

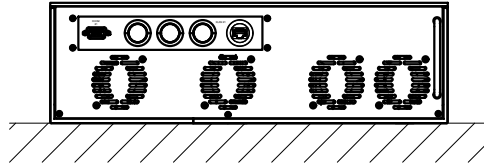

FRONT VIEW



130

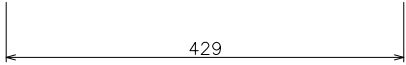

429